

HMD-1503

MODERN TV FLOOR STAND

hamood



Material
Steel, Plastic



Color
White



Weight Capacity
50kg (110lbs)



VESA Compatible
100x100, 600x400



TV Screen Size
40"-75"



Shelf Capacity
5kg (11lbs)



Swivel Range
+30°~-30°



Stand Height
50"~56"

<https://hamoodtv.com>

HMD-1503

MODERN TV FLOOR STAND



Perfect Home & Office TV Floor Stand: The Ultimate Solution for Your Entertainment Setup!

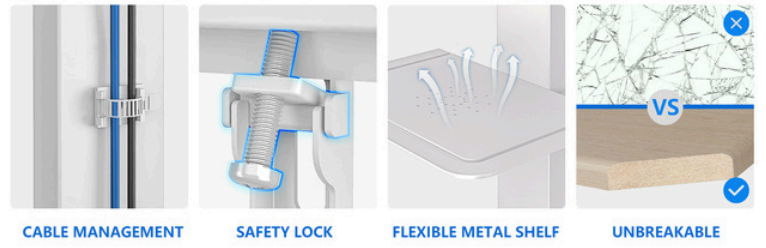
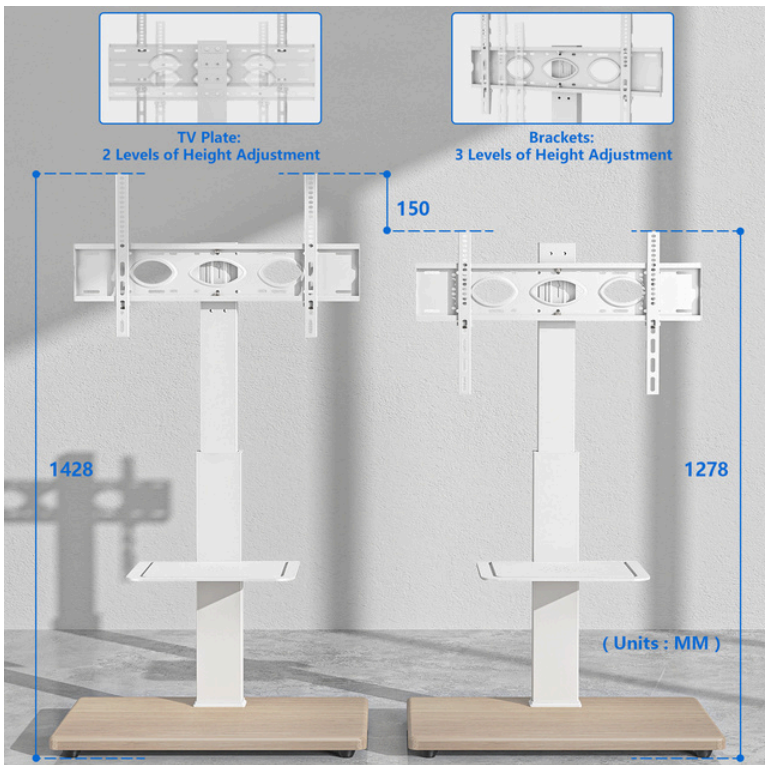

HMD-1503

MODERN TV FLOOR STAND

hamood

WHAT ELSE YOU NEED?

Elevate your home entertainment experience with our high-quality MODERN TV FLOOR STAND.

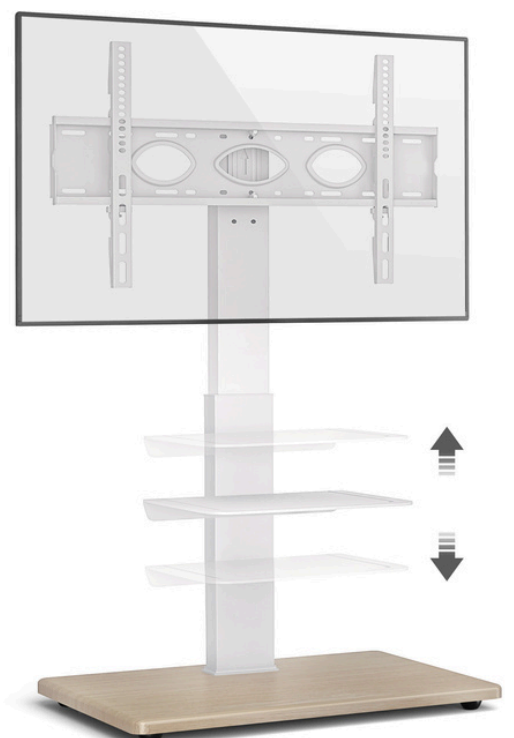
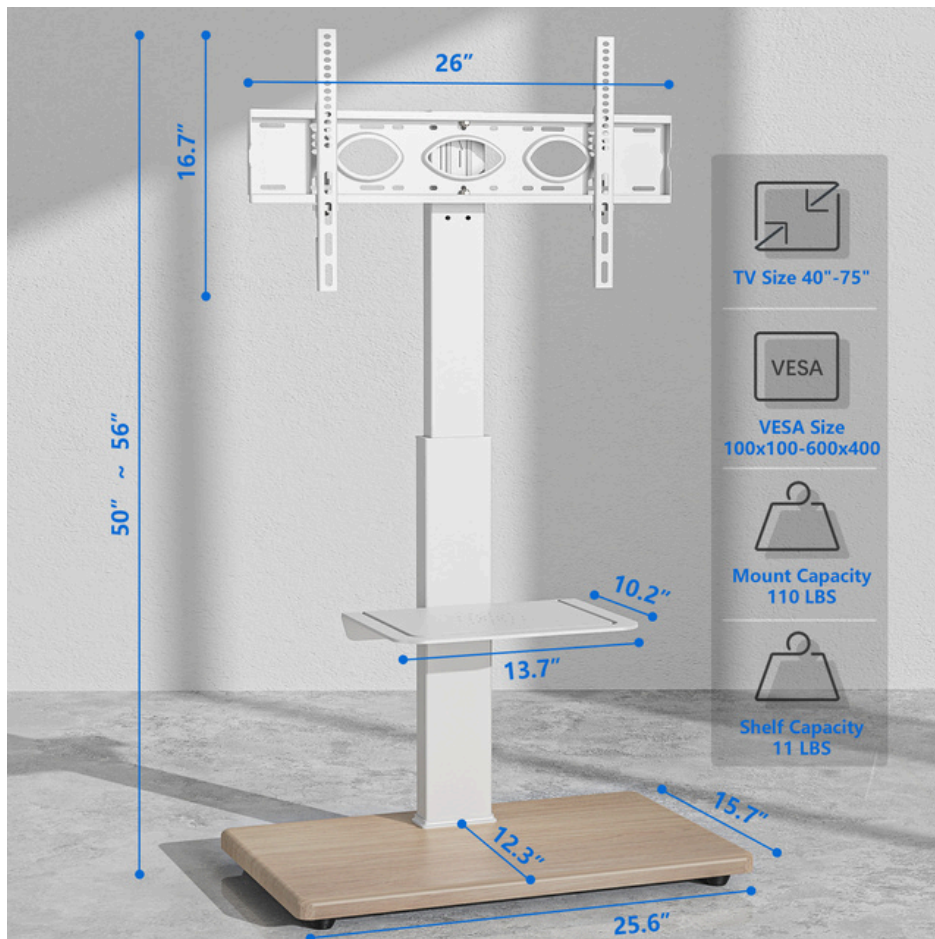

Adjustable Height:

The TV Floor Stand offers a customizable height range between 50" and 56", providing the flexibility to achieve the perfect viewing angle and setup for any room. Whether you're watching your favorite show from the comfort of your couch or engaging in an intense gaming session, this adjustable feature ensures that your TV is always at eye level, reducing strain on your neck and eyes. The effortless height adjustment mechanism allows you to easily modify the stand to fit your specific needs, enhancing your overall viewing experience and creating an ideal entertainment environment.

<https://hamoodtv.com>

HMD-1503

MODERN TV FLOOR STAND

hamood

Product Category: TV FLOOR Stand

Color: White

Description:

Introducing our versatile and sturdy TV Floor Stand, perfect for TV screens ranging from 40 to 75 inches. This stand combines style, flexibility, and practicality to enhance your viewing experience.



FEATURES

- **Screen Compatibility:** Accommodates a wide range of TV screen sizes from 40" to 75", ensuring a perfect fit for various models.
- **VESA Compatibility:** Supports VESA mounting patterns, ranging from 100x100 to 600x400, for versatile installation options.
- **Mount Capacity:** Designed to hold TVs up to 50kg (110lbs), providing reliable and sturdy support.
- **Shelf Capacity:** Includes an additional shelf with a capacity of 5kg (11lbs) for convenient placement of media devices or accessories.
- **Adjustable Height:** Stand height adjustable between 50" and 56" to achieve the ideal viewing angle and setup.
- **Cable Management:** Integrated cable management system to keep your entertainment area neat and organized.

Upgrade your living space with a TV Floor Stand that merges style, durability, and convenience. Experience the perfect blend of practicality and elegance, making your TV viewing experience more enjoyable and comfortable.